

**RETEKESS**

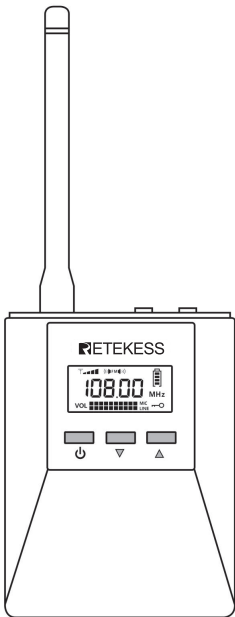

**TR506**  
FM TRANSMITTER

## **Thanks for buying the TR506 portable FM transmitter.**

Before you use this transmitter for the first time, please read the user manual carefully and operate the device following the instructions. It is multi-functional device but easy to operate. We sincerely hope our products will bring you happy experience.

### **1. Attention before use**

- 1) Only professional engineers can do the repair work.
- 2) Don't power on the transmitter without connecting the antenna.
- 3) Don't use the transmitter in explosive environment. (such as gas station, natural gas or steam)
- 4) Don't put the transmitter in extreme dusty, damp or hot places.
- 5) Please use the transmitter following the local regulations.
- 6) Please try not to use the transmitter in thunder/storm weather.

### **2. Main Characteristics:**

- 1) This transmitter uses professional transmitting transistors, it gives excellent audio quality. The audio port and microphone port are independent from each other, the input signal will be processed independently too, this decrease the loss of sound quality in a large extent.
- 2) The Power output is 4 levels adjustable; choose different power in different situation can avoid interference to the environment around.
- 3) This transmitter is equipped with special antenna; it is stable and reliable in transmitting a relative far range.
- 4) This transmitter uses 1000mAh Li-ion battery, its high capacity enables a long working time up to 16 hours at the lowest power output mode.
- 5) MONO/STEREO adjustable, easy to use.

### 3. Operation Instruction:

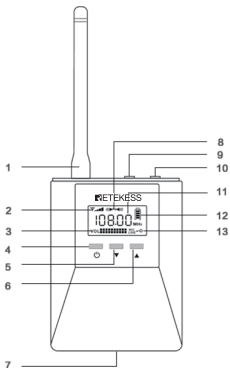

#### Appearance and Function

1. Antenna port
2. RF power display
3. Line-in/Microphone Volume
4. Power button, Function shifting
5. Reduce/Lock the buttons
6. Increase/Sound channel adjust
7. Battery Charging Port
8. Stereo status indicator
9. Microphone Port
10. Line-in port
11. Frequency Indicating
12. Battery indicator
13. Button locking indicator

#### 1). Battery cover Install/removing:

- A. Install the battery cover by inserting its legs to the holes on the back of transmitter, then push in (Picture A), and Press until it's locked tightly (Picture B).

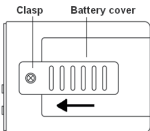

(Picture A)

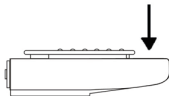

(Picture B)

- B. Hold the back of the cover and open it a little (Picture C), then pull out the cover from the slot (Picture D).

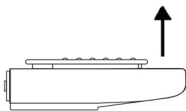

(Picture C)

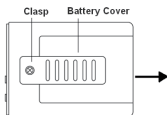

(Picture D)

## 2). Antenna Install/Uninstall (This is anti-screw direction antenna)

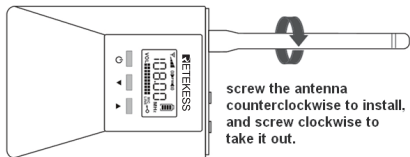

## 3). Power ON/OFF

- A. When the transmitter is OFF, press and hold **【⏻】** to power on.  
B. When the transmitter is in working status, press and hold **【⏻】** to power off.

## 4). Microphone Volume Setting

Press **【🔊】**, the MIC icon starts flashing, press **【▼】** to reduce the volume and press **【▲】** to increase.

## 5) Line-in Volume Setting

Press **【🔊】**, the "LINE" icon starts flashing, press **【▼】** to reduce the volume and press **【▲】** to increase.

## 6) Frequency Setting

Press **【⏻】** , The "MHz" icon starts flashing, press **【▼】** to turn down frequency, and press **【▲】** to turn up.

## 7) RF Power Setting

Press **【⏻】** , the " " icon starts flashing, press **【▼】** to reduce the broadcasting power and press **【▲】** to increase.

## 8) Button lock/unlock function

- A. Under normal working status, press and hold **【▼】** , the screen will show **【🔒】** which means the other buttons are all locked.
- B. Under button locking status, press and hold **【▼】** , the screen will show **【🔓】** which means the buttons are unlocked.

## 9) Stereo/Mono adjustable

Under normal working status, press and hold **【▲】** to shift between stereo/mono, when the screen shows **【🔊】** , it means the current sound mode is Stereo. When the screen doesn't show **【🔊】** , it means the current sound mode is Mono.

## 10) Battery charging

- (1) Connect the battery charger(DC5V) with transmitter via the USB line, the icon **【🔋】** starts flashing, the battery begins charging.
- (2) When battery is full after charge, the **【🔋】** icon will stop flashing. Usually it's about 5hours to charge battery full.

## 11) Reminder: Battery charging can be done no matter the transmitter is ON or OFF. Please kindly note the following items:

- A. When the icon **【🔋】** shows empty, it means battery is low and needs to charge as soon as possible.
- B. When charging battery as transmitter is ON, the transmitting power will be automatically shifted to the minimum level, this is a normal phenomenon.
- C. When charging battery as transmitter is OFF, there is nothing showing on the screen.
- D. When the transmitter is vacant for a long time, please take the battery out and put it in cool and dry environment.

#### 4. Main Specifications:

No	Product Name	Description	Quantity
1	Transmitter	TR506	1
2	FM antenna	Anti-screw direction	1
3	Li-ion battery	BL-5C 1000mAh	1
4	Car charger	With IC protection, Output voltage:DC 5V 1000mA	1
5	Lavaliere microphone	Stereo, gold plating, 1.2 meters with shielding function.	1
6	Audio cable	3.5 male to male	1
7	USB cable	USB to T port (MINI)	1
8	Packing box	Kraft box	1

#### 5. All configurations

No.	Item	Specification
1	Power supply	BL – 5C Li-ion battery, 3.7V 1000mAh
2	Frequency range	76~108MHz
3	Frequency Stability	±10PPM
4	Frequency stepping	100KHz
5	RF power output	( Level 1/2 /3/4) 0.01mW-10mW-100mW-200mW
6	Broadcasting range for reference	( Level 1/2 /3/4) 10m-100m-300m-400m
7	Working time	( Level 1/2 /3/4) 16h-10h-8h-5h
8	Battery Charging time	About 5hours, voltage is 5V.

9	Spurious, harmonic radiation	$\leq -30\text{dB}$
10	Sound distortion	$\leq 0.2\%$
11	Frequency response	50Hz~15000Hz
12	Input level	$\leq -15\text{ dBV}$
13	Frequency Modulation	$\pm 75\text{KHZ}$
14	SNR	$\geq 60\text{ dB}$
15	Device Size	82*60*22mm (Antenna not included)
16	Weight	About 67g(Battery not included)

## RF ENERGY EXPOSURE AND PRODUCT SAFETY GUIDE



ATTENTION!

Before using this radio, read this guide which contains important operating instructions for safe usage and RF energy awareness and control for compliance with applicable standards and regulations.

This radio uses electromagnetic energy in the radio frequency (RF) spectrum to provide communications between two or more users over a distance. RF energy, which when used improperly, can cause biological damage. All Reteless radios are designed, manufactured, and tested to ensure they meet government-established RF exposure levels. In addition, manufacturers also recommend specific operating instructions to users of the radios. These instructions are important because they inform users about RF energy exposure and provide simple procedures on how to control it. Please refer to the following websites for more information on what RF energy exposure is and how to control your exposure to assure compliance with established RF exposure limits: <http://www.who.int/en/>

### Local Government Regulations

When radios are used as a consequence of employment, the Local Government Regulations requires users to be fully aware of and able to control their exposure to meet occupational requirements. Exposure awareness can be facilitated by the use of a product label directing users to specific user awareness information. Your Reteless radio has a RF Exposure Product Label. Also, your Reteless user manual, or separate safety booklet includes information and operating instructions required to control your RF exposure and to satisfy compliance requirements.

### Radio License (if appropriate)

Governments keep the radios in classification, business radios operate on radio frequencies that are regulated by the local radio management departments (FCC, ISED, OFCOM, ANFR, BFTK, Bundesnetzagentur...). To transmit on these frequencies, you are required to have a license issued by them. The detailed classification and the use of your radios, please contact the local government radio management departments.

Use of this radio outside the country where it was intended to be distributed is subject to government regulations and may be prohibited.



## **Unauthorized modification and adjustment**

Changes or modifications not expressly approved by the party responsible for compliance may void the user's authority granted by the local government radio management departments to operate this radio and should not be made. To comply with the corresponding requirements, transmitter adjustments should be made only by or under the supervision of a person certified as technically qualified to perform transmitter maintenance and repairs in the private land mobile and fixed services as certified by an organization representative of the user of those services.

Replacement of any transmitter component (crystal, semiconductor, etc.) not authorized by the local government radio management departments equipment authorization for this radio could violate the rules.

### **FCC Requirements:**

- This device complies with part 15 of the FCC Rules. Operation is subject to the following two conditions:
  - (1) This device may not cause harmful interference, and
  - (2) this device must accept any interference received, including interference that may cause undesired operation.
- This equipment has been tested and found to comply with the limits for a Class B digital device, pursuant to Part 15 of the FCC Rules. These limits are designed to provide reasonable protection against harmful interference in a residential installation.

This equipment generates uses and can radiate radio frequency energy and, if not installed and used in accordance with the instructions, may cause harmful interference to radio communications. However, there is no guarantee that interference will not occur in a particular installation. If this equipment does cause harmful interference to radio or television reception, which can be determined by turning the equipment off and on, the user is encouraged to try to correct the interference by one or more of the following measures:

- Reorient or relocate the receiving antenna.
- Increase the separation between the equipment and receiver.
- Connect the equipment into an outlet on a circuit different from that to which the receiver is connected.
- Consult the dealer or an experienced radio/TV technician for help.

### **CE Requirements:**

- (Simple EU declaration of conformity) Henan Eshow Electronic Commerce Co.,Ltd declares that the radio equipment type is in compliance with the essential requirements and other relevant provisions of RED Directive 2014/

53/EU and the ROHS Directive 2011/65/EU and the WEEE Directive 2012/19/EU; the full text of the EU declaration of conformity is available at the following internet address: [www.retekess.com](http://www.retekess.com).

#### •Disposal

The crossed-out wheeled-bin symbol on your product, literature, or packaging reminds you that in the European Union, all electrical and electronic products, batteries, and accumulators (rechargeable batteries) must be taken to designated collection locations at the end of their working life. Do not dispose of these products as unsorted municipal waste. Dispose of them according to the laws in your area.



#### IC Requirements:

Licence-exempt radio apparatus

This device contains licence-exempt transmitter(s)/receiver(s) that comply with Innovation, Science and Economic Development Canada's licence-exempt RSS(s). Operation is subject to the following two conditions:

- (1) This device may not cause interference.
- (2) This device must accept any interference, including interference that may cause undesired operation of the device.

Le présent appareil est conforme aux CNR d'Industrie Canada applicables aux appareils radio exempts de licence. L'exploitation est autorisée aux deux conditions suivantes :

- (1) l'appareil ne doit pas produire de brouillage;
- (2) l'utilisateur de l'appareil doit accepter tout brouillage radioélectrique subi, même si le brouillage est susceptible d'en compromettre le fonctionnement.

#### RF Exposure Information

- DO NOT operate the radio without a proper antenna attached, as this may damage the radio and may also cause you to exceed RF exposure limits. A proper antenna is the antenna supplied with this radio by the manufacturer or an antenna specifically authorized by the manufacturer for use with this radio, and the antenna gain shall not exceed the specified gain by the manufacturer declared.
- DO NOT transmit for more than 50% of total radio use time, more than 50% of the time can cause RF exposure compliance requirements to be exceeded.
- During transmissions, your radio generates RF energy that can possibly cause interference with other devices or systems. To avoid such interference, turn off the radio in areas where signs are posted to do so.
- The device complies with RF specifications when the device used at 5mm from your body. Third-party belt-clips, holsters, and similar accessories used by this

device should not contain any metallic components. Body-worn accessories that do not meet these requirements may not comply with RF exposure requirements and should be avoided.

•DO NOT operate the transmitter in areas that are sensitive to electromagnetic radiation such as hospitals, aircraft, and blasting sites.

## Avoid Choking Hazard



Small Parts. Not for children under 3 years.

## Protect your hearing:



**WARNING**

- Use the lowest volume necessary to do your job.
- Turn up the volume only if you are in noisy surroundings.
- Turn down the volume before adding headset or earpiece.
- Limit the amount of time you use headsets or earpieces at high volume.
- When using the radio without a headset or earpiece, do not place the radio's speaker directly against your ear
- Use careful with the earphone maybe possible excessive sound pressure from earphones and headphones can cause hearing loss

**Note:** Exposure to loud noises from any source for extended periods of time may temporarily or permanently affect your hearing. The louder the radio's volume, the less time is required before your hearing could be affected. Hearing damage from loud noise is sometimes undetectable at first and can have a cumulative effect.



## Avoid Burns



**WARNING**

### Antennas

- Do not use any portable radio that has a damaged antenna. If a damaged antenna comes into contact with the skin when the radio is in use, a minor burn can result.

### **Batteries (If appropriate)**

•When the conductive material such as jewelry, keys or chains touch exposed terminals of the batteries, may complete an electrical circuit (short circuit the battery) and become hot to cause bodily injury such as burns. Exercise care in handling any battery, particularly when placing it inside a pocket, purse or other container with metal objects

### **Long transmission**

•When the transceiver is used for long transmissions, the radiator and chassis will become hot.

## **Safety Operation**



### **WARNING**

#### **Forbid**

- Do not use charger outdoors or in moist environments, use only in dry locations/conditions.
- Do not disassemble the charger, that may result in risk of electrical shock or fire.
- Do not operate the charger if it has been broken or damaged in any way.
- Do not place a portable radio in the area over an air bag or in the air bag deployment area. The radio may be propelled with great force and cause serious injury to occupants of the vehicle when the air bag inflates.

#### **To reduce risk**

- Pull by the plug rather than the cord when disconnecting the charger.
- Unplug the charger from the AC outlet before attempting any maintenance or cleaning.
- Contact Reteless for assistance regarding repairs and service.
- The adapter shall be installed near the equipment and shall be easily accessible
- Risk of explosion if battery is replaced by an incorrect type. Dispose of used batteries according to the instructions.
- Adapter shall be installed near the equipment and shall be easily accessible.
- The plug considered as disconnect device of adapter.

- The operating temperature of the EUT can't exceed the specified range.

### Approved Accessories



**WARNING**

- This radio meets the RF exposure guidelines when used with the Reteless accessories supplied or designated for the product. Use of other accessories may not ensure compliance with the RF exposure guidelines and may violate regulations.
- For a list of Reteless-approved accessories for your radio model, visit the following website: <http://www.Reteless.com>

## Warranty Card

Product model: \_\_\_\_\_ Date of purchase: \_\_\_\_\_

Serial Number: \_\_\_\_\_

Seller: \_\_\_\_\_ contact number: \_\_\_\_\_

Username: \_\_\_\_\_ contact number: \_\_\_\_\_

Address: \_\_\_\_\_ Zip code: \_\_\_\_\_

### Warranty description:

1. The warranty card is saved by the customer as the warranty certificate, and the loss is not compensated.
2. This card must be stamped and dated for sale to take effect.
3. This card must not be altered. Please confirm that the warranty card serial number matches the purchase machine number, otherwise it will be invalid.
4. The warranty period is one year. Chargers, batteries, headphones, antennas and feeders are consumables, not covered by warranty.
5. Users can choose the following ways to get repair service:
  - a. At the original purchase office.
  - b. Our company is in the local special maintenance point.

Cut along this line





CE FC RoHS



**Henan Eshow Electronic Commerce Co., Ltd**

Address: 7/F, Sanjiang Building, No.170 Nanyang Road, Huiji District,  
Zhengzhou, Henan, China

EU Importer: Germany Retevis Technology GmbH

Address: Uetzenacker 29,38176 wendeburg

Facebook: [facebook.com/RetekessWirelessSystem](https://www.facebook.com/RetekessWirelessSystem)

E-mail: [support@retekess.com](mailto:support@retekess.com)

Web: [www.retekess.com](http://www.retekess.com)



MADE IN CHINA